

Careers 20 CONVENTION 26

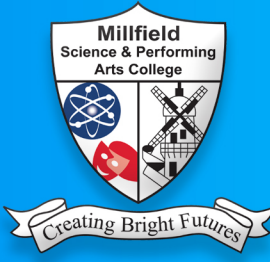

Career Atlas

Mapping your future



victrex



GREEN SPACE
TRANSFORMATIONS
COMMUNITY INTEREST COMPANY

Myerscough
College & University Centre
INSPIRING EXCELLENCE



4TH
MARCH
IN SPORTS HALL

THROUGHOUT THE DAY STUDENTS WILL HAVE THE OPPORTUNITY TO ATTEND THE CAREERS CONVENTION AND SPEAK TO EMPLOYERS AND COLLEGES ABOUT THE COURSES AND OPPORTUNITIES THAT ARE AVAILABLE ON LEAVING SCHOOL.

Be Exceptional



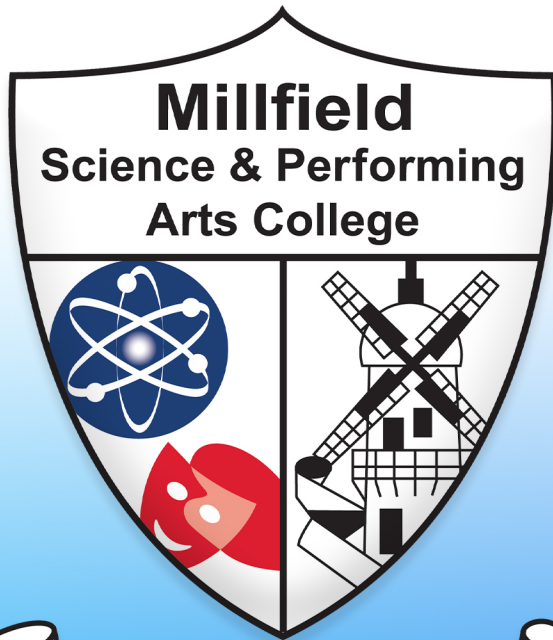

Creating Bright Futures

Be Exceptional

What's in it for you?

You will get a chance to:

- Explore a wide range of career opportunities
- Talk to experts in a selection of popular careers
- Investigate options in Employment, Training, Apprenticeships, Further Education and Higher Education
- Look at career opportunities which you might not have considered before.

What's on Where?

All the organisations will be based in the assembly hall. There may be many questions you feel you would like to ask. All of the companies/industries are here to offer their expertise and assistance.

Speak to our careers adviser

Mrs Arthur (based in the hall) or speak to **Mr. Grayston** or **Mrs. Draper** to arrange an appointment to meet in school.



NEED MORE INFORMATION?

Below are web links where you can research options, careers and future education.

Careerpilot

www.careerpilot.org.uk

Bitesize

www.bbc.co.uk/bitesize/careers

 **Apprenticeships**

www.apprenticeships.gov.uk

National Careers Service

www.nationalcareers.service.gov.uk

start 

www.startprofile.com

WHO IS HERE?

INFORMATION ON:	ORGANISATION
Careers Advice:	Mrs. Arthur (School Careers Adviser)
Armed Forces:	British Army Careers, Royal Air Force, Royal Navy.
Further Education:	Blackpool 6 th Form College Blackpool & The Fylde College Blackpool & The Fylde College (Nautical College) Blackpool School of Arts Fleetwood Town Community Trust Myerscough College

The following organisations will be located in the hall.

Talk to them about their own training programmes.

Lancashire Police
Blackpool Teaching Hospital
Lancashire DWP
Lab Creative
BAE Systems
Prince's Trust
Vitrex Plc
Blackpool FC Trust
Westinghouse
Rolls Royce
AGC Chemicals
The Boathouse Youth
Volunteer Centre Blackpool
Little Explorers Nursery
Green Space Transformation

FIRE EXIT

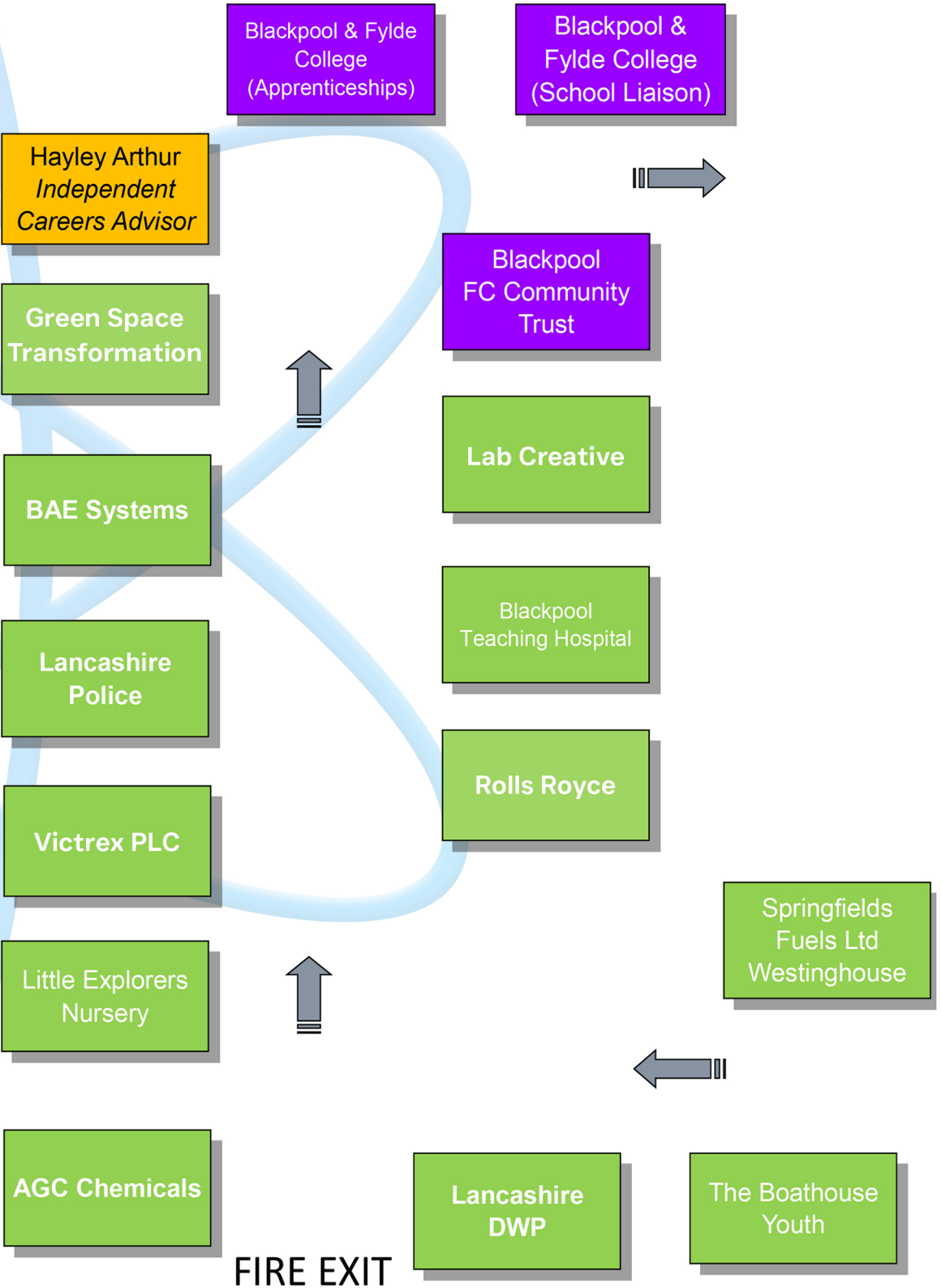

FIRE EXIT

Blackpool School of Arts



Myerscough College

Blackpool 6th Form

Volunteers
Centre Blackpool



Fleetwood Town
Sports College

Prince's Trust

Royal Air Force



British Army

Royal Navy

ENTRANCE

CAREERS CONVENTION COMPETITIONS

There are 3 different Careers Convention Competitions

1. Question Orienteering

On the next page are a number of questions to ask the employers and education providers. Simply ask the question and write a brief answer with who you asked. Try to ask each station at least one different question.

2. What they are looking for?

Create an overview for one of the employers or education providers, including which employability skills and qualifications they look for when employing / enrolling a new candidate.

3. What you can offer them?

Choose one of the employers or education providers and explain why you think you would be an ideal candidate for them. Think about what you have been told.

Hand in your answers as you are leaving the convention.

**Winners will each receive
a £10 Love to Shop voucher**



LOVE2SHOP

QUESTIONS TO ASK EDUCATION PROVIDERS

Further Education Providers

<i>What makes this college / 6th Form special?</i>	
<i>What are the GCSE entry requirements?</i>	
<i>What is the college / 6th Form proud of?</i>	
<i>What is the average class size?</i>	
<i>What is the process to enrol and how easy/difficult is it?</i>	
<i>Do you offer taster session/days?</i>	

Higher Education Providers

<i>What are the entry requirements needed to get on a degree course?</i>	
<i>How much does it cost to complete a degree course?</i>	
<i>What financial support is available?</i>	
<i>What is a typical day like at university?</i>	
<i>Do I have to live in the area to complete your degree course?</i>	
<i>What work do I need to complete on my degree course?</i>	

QUESTIONS TO ASK EMPLOYERS

<i>What types of careers are available in your company?</i>	
<i>What are the skills and experiences you're looking for in an ideal candidate?</i>	
<i>What does a typical day look like in this job sector?</i>	
<i>What are the stages of the hiring process?</i>	
<i>What's your favourite part about working for the company?</i>	
<i>What is the key to succeeding in this role?</i>	

QUESTIONS TO ASK YOUR CAREERS ADVISOR

<i>What topic of conversation would you never mention in your first interview?</i>	
<i>What would you usually include in a CV?</i>	
<i>Should you take your CV to an interview?</i>	
<i>What's the best website to apply for apprenticeships?</i>	
<i>Do you need a GCSE in a subject to study it at A-level?</i>	
<i>What's the difference between Blackpool and Fylde College and Blackpool Sixth Form?</i>	

WHAT ARE THEY LOOKING FOR?

Employer or Education provider

What is the number 1 employability skill or quality
they look for and why?.....

What other employability skills or qualities are important?
.....

What qualifications do I need to enrol or apply?
.....
.....

WHAT ARE THEY LOOKING FOR?

Employer or Education provider

My number 1 employability skill is.....

I am interested in this course / job because.....

The qualifications and skills I need are.....

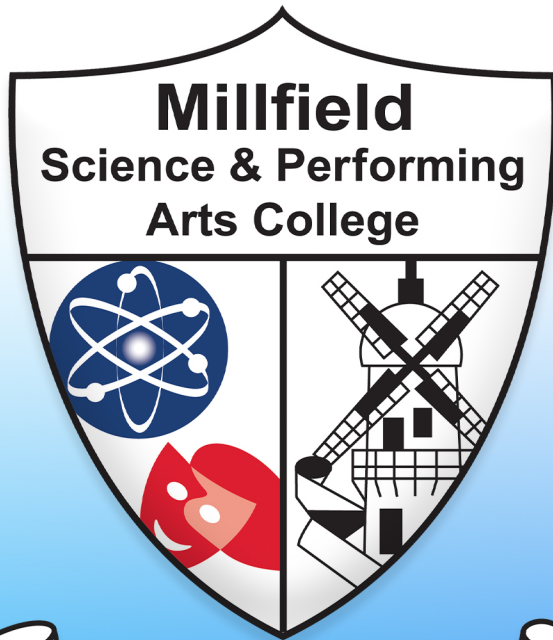

Creating Bright Futures

Be Exceptional